

# OCEAN

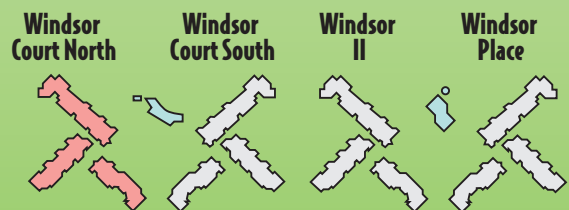
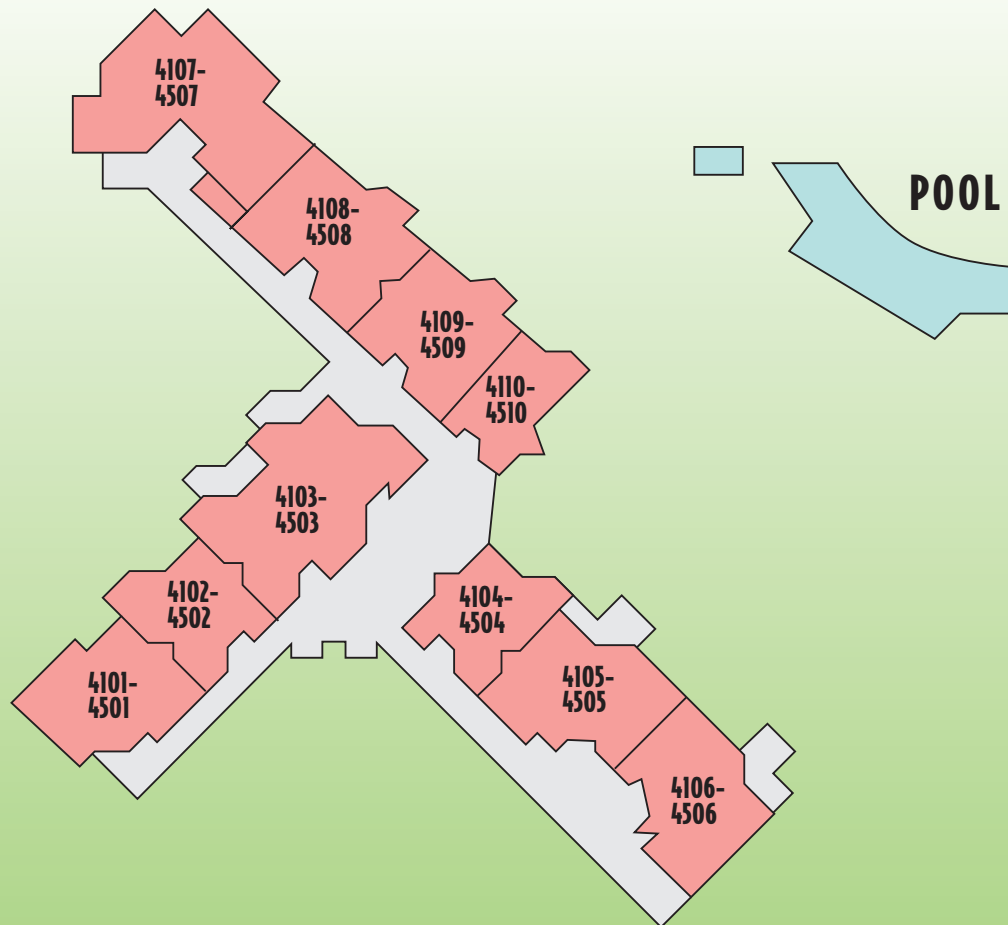

## WINDSOR COURT NORTH

### DIRECTIONS

Coming North or South on I-95, take EXIT 8, which is Hwy 278. Proceed on Hwy 278 toward Hilton Head - it is approximately 18 miles until you reach the two Hilton Head bridges.

Stay on Hwy 278 Business (William Hilton Parkway) for about 7 miles. Palmetto Dunes will be on your LEFT. Take a left at the light into PALMETTO DUNES (Queens Folly Rd). Continue STRAIGHT through the gate. Please make sure you have your pass displayed on your dash when approaching the Palmetto Dunes Guard Gate. Continue approx. 1/2 mile where you will pass the brick Leamington entrance. Windsor Court North will be past the Hampton Buildings on your LEFT.

### PHYSICAL ADDRESS FOR MAP SEARCH

51 Ocean Lane, Hilton Head Island, SC 29928